

LUSTY EMS

Dolly

HIGH QUALITY • DURABLE • STRONG



The Lusty EMS Dolly is a rugged, multi-purpose dolly, with a highly efficient sandwich plate construction and galvanised frame as standard. The Lusty EMS Dolly is uncomplicated and robust, giving you the reliability you have come to expect from Lusty EMS.

The Lusty EMS Dolly's modular design also means there are a variety of available options, which can be easily configured to suit many requirements. Options such as tandem or tri-axle configuration, three-position drawbar, paint alternatives and customised drawbar lengths give the Lusty EMS Dolly great flexibility for any transport task.

Features & Benefits



Sandwich Plate Chassis - 30% stronger than RHS with no tare weight penalty



Angled Drawbar Tube - to allow product and road debris to fall off (non-angled design available as an option)



Galvanised Finish - for long lasting durability and no paint chips (painted finish also available)



3 Position Interchangeable Drawbar Height - for optimum drawbar angle

LUSTY EMS

Dolly

Dimensions (nominal)

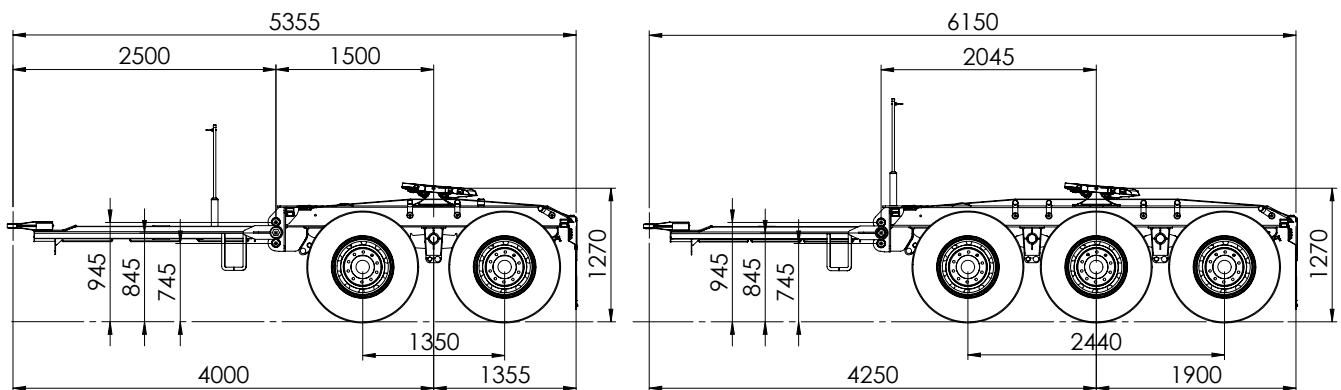

Unit Specifications (nominal)

Frame	Sandwich plate style subframe
Drawbar	Length made to order
Drawbar Height	3 interchangeable positions
Tow Eye	50mm weld in tow eye
Drawbar Prop	Flip over pipe
Guards	Rubber flexible guards
Wheels	Steel wheels 10/285 PCD 8.25 x 22.5
Couplings	Front of subframe on antenna
Tyres	11R 22.5 tyres

Mudguards	Flaps fitted to rear
Voltage / Lamps	Multi-volt to A.D.R 13 / LED multi-volt
Finish	Galvanised drawbar, subframe and front guards White rear channel, hubs painted
Suspension	VE50 heavy duty spring suspension - 9 leaf
Axles	Maxus, 10 stud 285mm pcd steel hubs
Brakes	Drum brakes to A.D.R 38/03
Turntable	1270mm nominal unladen height, V.Orlandi pedestal foot, bolt on - (185mm)

Options (some available at additional expense)

- Suspension
 - VE50 10 leaf or 13 leaf spring
 - Hendrickson HT230
 - Hendrickson Intraax
 - Meritor CS9
 - BPW AL2
 - BPW Heavy Duty
- Paint
 - Enamel
 - 2K
 - Painted turntable
- Bolt in Tow Eye
- Aluminium Walkway (Bolt On)
- Top Winding Drawbar Support Jack
- Turntables (Bolt On)
 - Jost (185mm pedestal)
 - Holland (165mm pedestal)
 - K-Hitch (200mm ballrace)⁺
- Radius Guards
- Mudflaps
 - Front and rear of suspension
 - Full width across front of suspension and/or rear
 - Behind each wheel (with radius guards only)
 - Combinations of the above
- Couplings
 - Rear of subframe
 - Front and rear of subframe
 - Hydraulics
- Dump Valve (For Airbag Suspension Option)
- Park Release Valve
- Load Gauge
- Drawbar
 - Varying lengths
 - Non-angled tube

*Fully custom built dollies are available on request.
For more information please contact your nearest Lusty EMS Dealer.*

⁺ Increases turntable height to 1300mm overall

MaxiTRANS provides the information contained herein in good faith, based upon the right to change specifications without notice. However, MaxiTRANS accepts no liability, either direct or indirect for any loss or consequential loss that may result from the application of this information. Purchasers must conduct their own enquiries to ensure that the products are suitable for their own particular purposes. Any comments made regarding products and construction are made on an information basis, not as a recommendation. Illustrations may show equipment that is available at extra cost. Lusty EMS is a registered trademark of the MaxiTRANS Group. MaxiTRANS Australia Pty Ltd. ABN 95 081 151 699. Printed 08/14.

Visit **www.lustyems.com.au**
or scan the QR code to the right to find your nearest dealer

